

Rev-A-Shelf Wood Swing Out Pantry

For both Base and Tall Pantry cabinets: 25", 45", 51", 57"

Sales Bulletin
Dec 2011

The 4WP Series Swing-Out Wood Pantry System fits both Base and Tall Pantry cabinets. It features industrial piano hinge and adjustable inside shelves with chrome rails. Also, you can add or remove chrome bars to the top of the units.

Solid 1/2" maple has a UV-cured, clear finish. Complete kit includes two swing-out units and two door storage units with adjustable mounting brackets.

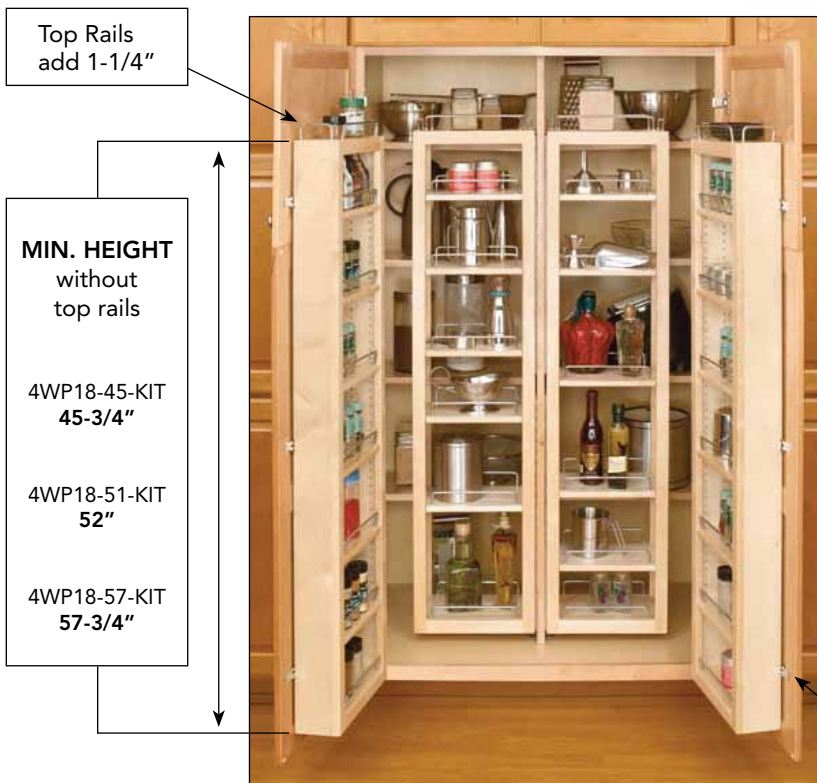
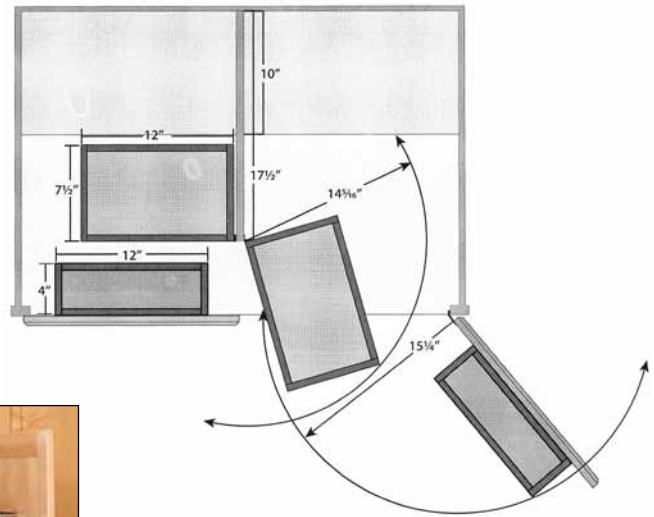

MIN. HEIGHT
without
top rails

4WP18-45-KIT
45-3/4"

4WP18-51-KIT
52"

4WP18-57-KIT
57-3/4"

MIN. HEIGHT

4WBP18-25-KIT
25-3/4"

Door Mount Brackets allow
up to 5" of adjustment!

Code	Description	Dimensions	List
4WBSP18-25	25" Swing Out Pantry (w/hdwr) Single	12" W x 7-1/2" D x 25" H	\$ 104.20
4WBDP18-25	25" Pantry Door Unit (w/hdwr) Single	12" W x 4" D x 25" H	93.38
4WBP18-25-KIT	25" Swing Out Pantry Kit - Includes (2) 4WBSP18-25 and (2) 4WBDP18-25		377.31
4WSP18-45	45" Swing Out Pantry (w/hdwr) Single	12" W x 7-1/2" D x 45" H	174.63
4WDP18-45	45" Pantry Door Unit (w/hdwr) Single	12" W x 4" D x 45" H	135.90
4WP18-45-KIT	45" Swing Out Pantry Kit - Includes (2) 4WDP18-45 and (2) 4WSP18-45		611.67
4WSP18-51	51" Swing Out Pantry (w/hdwr) Single	12" W x 7-1/2" D x 51-1/4" H	185.33
4WDP18-51	51" Pantry Door Unit (w/hdwr) Single	12" W x 4" D x 51-1/4" H	144.37
4WP18-51-KIT	51" Swing Out Pantry Kit - Includes (2) 4WSP18-51 and (2) 4WDP18-51		649.36
4WSP18-57*	57" Swing Out Pantry (w/hdwr) Single	12" W x 7-1/2" D x 57" H	191.98
4WDP18-57*	57" Pantry Door Unit (w/hdwr) Single	12" W x 4" D x 57" H	145.67
4WP18-57-KIT*	57" Swing Out Pantry Kit - Includes (2) 4WDP18-57 and (2) 4WSP18-57		654.06

*Top Rail NOT included with these models

Dealer No. B