

°eluma Aluminum Frame LED Panel Quote Request/ Order Form



Request for: Quote Order

SCAN FOR OPTIONS

Company: _____
 Contact Name: _____
 Address: _____

 Phone #: _____
 Fax #: _____
 Email: _____

Date: _____
 PO Number (if applies): _____

1 Profile Type: EL001
 EL002

2 Profile Finish: (select one)
 Anodized Aluminum
 Natural Aluminum
 Brushed Stainless Steel Look

Powder Coat: Oil Rubbed Bronze
 Black
 White

Sublimation: Maple
 Cherry

3 Insert Type: (select one)
 Acrylic - Abrasion resistant coating on both sides
Weight capacity for acrylicshelves = 75 lbs TOTAL. Acrylic is abrasion resistant but not scratch proof.

Glass - Tempered 1/4" etched lines @ 1/4" spacing
Weight capacity for glass shelves = 75 lbs per SF. Glass may contain minor imperfections which are inherent to the mfg process.

Glass - Tempered 1/16" etched lines @ 1/4" spacing
Weight capacity for glass shelves = 75 lbs per SF. Glass may contain minor imperfections which are inherent to the mfg process.

4 LED Color Temperature: (select one)
 Warm - 3500K (Ambient Light) 50K Hour Useful Life
 Daylight - 6500K (Natural Light) 50K Hour Useful Life
 RGB Color Changing LED (available soon) 50K Hour Useful Life

5 Transformers:

QTY: ___ DC-ELT18-CON:
 12V DC 18W max. - 6 LF of LED Panels

QTY: ___ DC-ELT60-CON:
 12V DC 60W max. - 20 LF of LED Panels

6 Wiring Components:

OPTION A: Fixed Shelf/ Panel OR **OPTION B: Adjustable Shelf**

QTY: ___ LED-PKT-2M:
 2m (79") power lead for direct wiring of panel
(1REQUIRED per panel for all fixed applications)

QTY: ___ EXT-2M:
 2m (79")extension wire to LED-PKT-2M (optional)

QTY: ___ MAG-TR-1M
 1m (39 3/8") power bar track
(1REQUIRED per cabinet)

QTY: ___ MAG-ADP
 Magnetic adapter **(1 per shelf)**

QTY: ___ EXT-2M:
 2M (79") extension b/w power bar & transformer
(1 REQUIRED per power bar)

7 Optional Components: Dimmers/ On-Off Switches:

QTY: ___ DIMMER-12V:
 Remote control/ for up to 96W of LEDs

QTY: ___ RDSW-2M-WH: white round rocker switch w/ 2m (79") lead

QTY: ___ RDSW-2M-BL: black round rocker switch w/ 2m (79") lead

Wall Mounting Hardware Kit:
for use with EL002 only

QTY: ___ EL-CSB-A (aluminum)

QTY: ___ EL-CSB-B (black)

Item	Qty	Width	*Depth/ Height	in./ mm	Exit Wire Options <small>Wire Exit Locations: Front/Bottom or Back/ Top AND Left/ Right Wire Length: 3" Standard, 20" Max.* *Back/Top exit, subtract depth dimension from max. available wire exit length.</small>	Distributor Use Only	
						Price	Ext. Price
Ex.	3	29 5/16"	11 1/2"	in.	Back - Right - 3"		
1							
2							
3							
4							

* subtract 1/2" from shelf depth in adjustable shelf applications for power bar track
 * subtract 1/4" from shelf depth in fixed shelf applications

Notes: _____

Transformers		
Other Components		
Subtotal		
Shipping		
Total		

Ask us about our aluminum frame cabinet doors.

°eluma application specifications

for additional information or customer support please call: (877) 332-3396

Exit Wire Options (choose one)

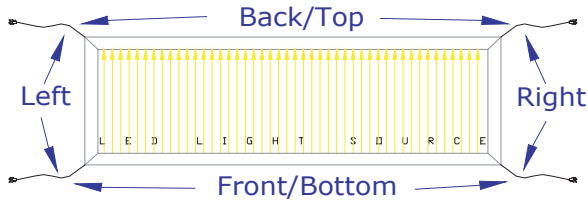

Choose exit wire location (must be a corner)

Specify exit wire (pigtail) length: Std.3", *Max.20"

*Back/Top wire exit (opposite LEDs), subtract shelf/panel depth dimension from 20" maximum available wire exit length.
(Example: 12" shelf/panel depth will have 8" available wire exit length)

Fixed Shelving (Direct Wiring: **OPTION A**)

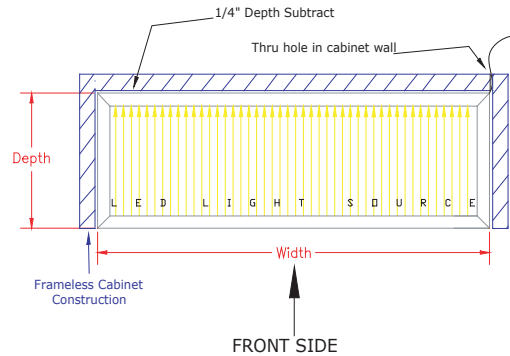

Adjustable Shelving (**OPTION B**)

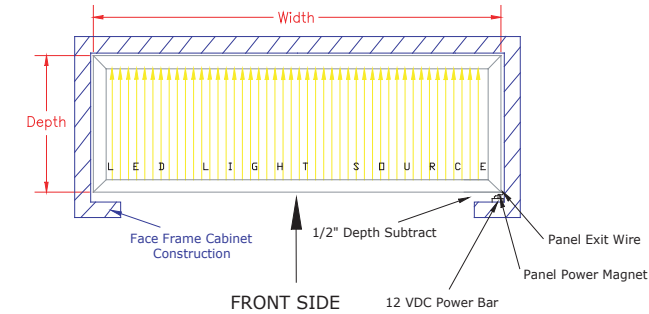

Backsplash Panel (Direct Wiring: **OPTION A**)

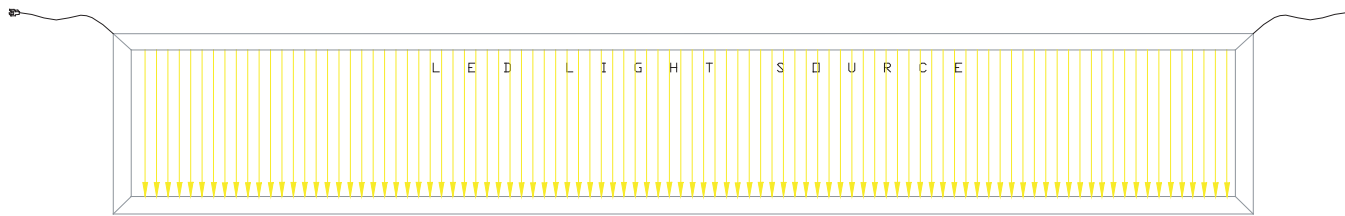

If overall backsplash width/length is greater than 60", two exit wires are required on the illuminated backsplash.

White backsplash acrylic backer panel included to eliminate transparency through illuminated backsplash.

Attachment of backsplash to wall is the responsibility of the installer.
(recommended backsplash installation methods are mounting bracket, screw to wall, or adhesive)

Wall Mount Shelving (**OPTION A or B**)

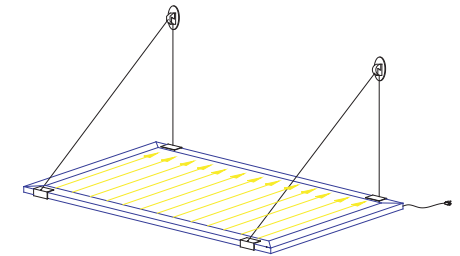

Wall Mount Shelving can be direct wire or adjustable.

Electrical Components

°eluma Panel

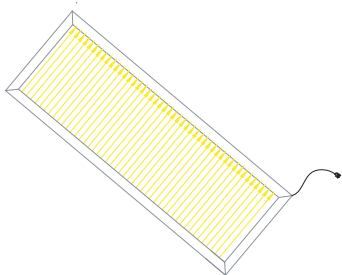

(REQUIRED)

+

Fixed Shelf/
Panel Components:
(OPTION A)

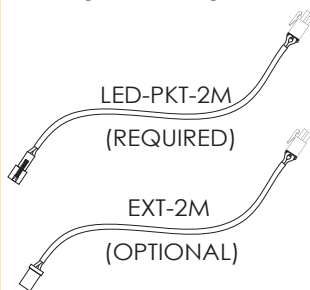

OR

Adjustable Shelf/
Panel Components:
(OPTION B)

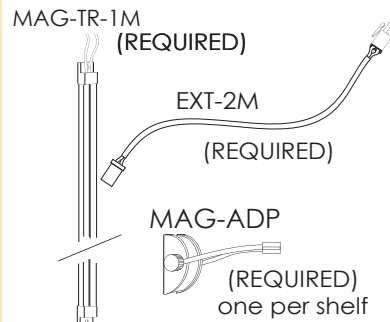

+

On-Off Switch Components:
(OPTIONAL - CHOOSE 1)

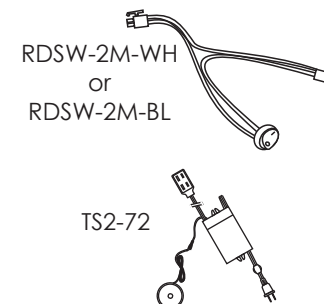

+

Power Components:
(REQUIRED - CHOOSE 1)

